

## CITY OF VAUGHAN

### **EXTRACT FROM COUNCIL MEETING MINUTES OF SEPTEMBER 26, 2017**

Item 16, Report No. 31, of the Committee of the Whole, which was adopted without amendment by the Council of the City of Vaughan on September 26, 2017.

16

#### **ASSUMPTION – YESHIVA (NER ISRAEL) PHASE 1 SUBDIVISION PLAN OF SUBDIVISION 65M-3650 (19T-98V11) WARD 4, VICINITY OF RUTHERFORD ROAD AND BATHURST STREET**

The Committee of the Whole recommends approval of the recommendation contained in the following report of the Deputy City Manager, Planning and Growth Management and the Director of Development Engineering and Infrastructure Planning, dated September 19, 2017:

#### **Recommendation**

The Deputy City Manager, Planning and Growth Management and the Director of Development Engineering and Infrastructure Planning, in consultation with the Director of Transportation Services, Parks and Forestry Operations, the Director of Environmental Services, the Director of Financial Planning and Development Finance and Deputy City Treasurer recommend:

1. That Council enact the necessary by-law assuming the municipal services that are set out in the Subdivision Agreement for Plan 65M-3650 and that the Municipal Services Letter of Credit be released.

#### **Contribution to Sustainability**

The municipal services recommended for assumption in this report have been designed and constructed in accordance with City standards which include consideration for sustainability.

#### **Economic Impact**

Upon assumption of this subdivision, approximately 1.9 lane kilometers of roadway and associated municipal services including sewers, watermain, street lighting, streetscaping, sidewalk, etc., will be added to the City's network of infrastructure. This additional infrastructure is valued at \$2,197,620 and will incur the normal expense associated with annual operation and maintenance activities of approximately \$35,250 shown on the following chart:

Item Description	As Constructed Costs	Approximate Annual Operating Costs (*)
Watermain	\$ 276,660	\$ 6,670
Sanitary sewers	\$ 220,480	\$ 4,320
Storm sewers	\$1,109,700	\$ 1,470
Road	\$ 373,540	\$14,700
Trees/Streetscaping/Landscaping	\$ 143,980	\$ 4,610
Streetlighting	\$ 73,260	\$ 3,480
Totals	\$2,197,620	\$35,250

*(\*) Estimated Annual Operating Costs based on information from Environmental Services and the Transportation Services and Parks & Forestry Operations Departments.*

The life cycle costs associated with this additional infrastructure will be accounted for in the City's future multi-year budgets.

#### **Communications Plan**

The pertinent City departments will be notified of the assumption of this subdivision.

## **CITY OF VAUGHAN**

### **EXTRACT FROM COUNCIL MEETING MINUTES OF SEPTEMBER 26, 2017**

Item 16, CW Report No. 31 – Page 2

#### **Purpose**

The purpose of this report is to inform Council that the municipal services constructed pursuant to the Subdivision Agreement between Bathurst Contwo Investments Limited and the City are complete and can be considered for assumption by the City.

#### **Background - Analysis and Options**

The Yeshiva (Ner Israel) Phase 1 Subdivision, Plan of Subdivision 65M-3650, is a residential development comprised of 91 single lots, 6 part blocks, 4 townhouse units and 1 woodlot block and is located west of Bathurst Street and south of Rutherford Road in Ward 4 as shown on Attachment No.1.

The Subdivision Agreement with Bathurst Contwo Investments Limited was executed on November 15, 2002 and the Plan of Subdivision was subsequently registered on March 12, 2003. The construction of the roads and municipal services in Plan 65M-3650 was considered substantially complete on March 1, 2011.

The Developer has maintained the municipal services in the subdivision during the required minimum thirteen month maintenance period and has rectified all deficiencies. All documents required for assumption have been received and the grading of all lots in the subdivision has been certified by the developer's engineering consultant.

Development inspection staff, in conjunction with the developer's consulting engineer, has conducted all necessary inspections of the municipal services and are now satisfied with the extent of the work.

Clearances have been received from all pertinent City Departments including Development Engineering and Infrastructure Planning, Development Planning, Building Standards, Transportation Services, Parks and Forestry Operations, Parks Development, Environmental Services and Office of the City Clerk. In addition, the Financial Planning and Development Finance department has confirmed that all of the City's financial requirements associated with this subdivision have been satisfied.

Accordingly, Bathurst Contwo Investments Limited has requested the municipal services constructed in conjunction with the Yeshiva (Ner Israel) Phase 1 Subdivision Agreement be assumed by the City.

#### **Relationship To Term of Council Service Excellence Strategy Map (2014-2018)**

The construction of the municipal services in the Yeshiva (Ner Israel) Phase 1 Subdivision and its assumption are consistent with the initiatives outlined in the Term of Council Service Excellence Strategy Map. The assumption of these municipal services will:

- Invest, renew and manage infrastructure and assets;
- Attract investment and create jobs;
- Continue to ensure the safety and well-being of citizens; and
- Continue to cultivate an environmentally sustainable city.

#### **Regional Implications**

There are no Regional implications with respect to the assumption of the municipal works within this subdivision development.

**CITY OF VAUGHAN**

**EXTRACT FROM COUNCIL MEETING MINUTES OF SEPTEMBER 26, 2017**

Item 16, CW Report No. 31 – Page 3

**Conclusion**

The construction of the roads and municipal services associated with the Yeshiva (Ner Israel) Phase 1 Subdivision, Plan of Subdivision 65M-3650, has been completed in accordance with the subdivision agreement. Accordingly, it is recommended that the roads and municipal services in 65M-3650 be assumed and the Municipal Services Letter of Credit be released.

**Attachment**

1. Location Map

**Report prepared by:**

Kevin Worth, Engineering Technologist - Development, ext. 8670

Frank Suppa, Manager of Development Inspection and Grading, ext. 8073

(A copy of the attachments referred to in the foregoing have been forwarded to each Member of Council and a copy thereof is also on file in the office of the City Clerk.)

**ASSUMPTION – YESHIVA (NER ISRAEL) PHASE 1 SUBDIVISION  
PLAN OF SUBDIVISION 65M-3650 (19T-98V11)  
WARD 4, VICINITY OF RUTHERFORD ROAD AND BATHURST STREET**

**Recommendation**

The Deputy City Manager, Planning and Growth Management and the Director of Development Engineering and Infrastructure Planning, in consultation with the Director of Transportation Services, Parks and Forestry Operations, the Director of Environmental Services, the Director of Financial Planning and Development Finance and Deputy City Treasurer recommend:

1. That Council enact the necessary by-law assuming the municipal services that are set out in the Subdivision Agreement for Plan 65M-3650 and that the Municipal Services Letter of Credit be released.

**Contribution to Sustainability**

The municipal services recommended for assumption in this report have been designed and constructed in accordance with City standards which include consideration for sustainability.

**Economic Impact**

Upon assumption of this subdivision, approximately 1.9 lane kilometers of roadway and associated municipal services including sewers, watermain, street lighting, streetscaping, sidewalk, etc., will be added to the City's network of infrastructure. This additional infrastructure is valued at \$2,197,620 and will incur the normal expense associated with annual operation and maintenance activities of approximately \$35,250 shown on the following chart:

Item Description	As Constructed Costs	Approximate Annual Operating Costs (*)
Watermain	\$ 276,660	\$ 6,670
Sanitary sewers	\$ 220,480	\$ 4,320
Storm sewers	\$1,109,700	\$ 1,470
Road	\$ 373,540	\$14,700
Trees/Streetscaping/Landscaping	\$ 143,980	\$ 4,610
Streetlighting	\$ 73,260	\$ 3,480
Totals	\$2,197,620	\$35,250

*(\*) Estimated Annual Operating Costs based on information from Environmental Services and the Transportation Services and Parks & Forestry Operations Departments.*

The life cycle costs associated with this additional infrastructure will be accounted for in the City's future multi-year budgets.

**Communications Plan**

The pertinent City departments will be notified of the assumption of this subdivision.

## **Purpose**

The purpose of this report is to inform Council that the municipal services constructed pursuant to the Subdivision Agreement between Bathurst Contwo Investments Limited and the City are complete and can be considered for assumption by the City.

## **Background - Analysis and Options**

The Yeshiva (Ner Israel) Phase 1 Subdivision, Plan of Subdivision 65M-3650, is a residential development comprised of 91 single lots, 6 part blocks, 4 townhouse units and 1 woodlot block and is located west of Bathurst Street and south of Rutherford Road in Ward 4 as shown on Attachment No.1.

The Subdivision Agreement with Bathurst Contwo Investments Limited was executed on November 15, 2002 and the Plan of Subdivision was subsequently registered on March 12, 2003. The construction of the roads and municipal services in Plan 65M-3650 was considered substantially complete on March 1, 2011.

The Developer has maintained the municipal services in the subdivision during the required minimum thirteen month maintenance period and has rectified all deficiencies. All documents required for assumption have been received and the grading of all lots in the subdivision has been certified by the developer's engineering consultant.

Development inspection staff, in conjunction with the developer's consulting engineer, has conducted all necessary inspections of the municipal services and are now satisfied with the extent of the work.

Clearances have been received from all pertinent City Departments including Development Engineering and Infrastructure Planning, Development Planning, Building Standards, Transportation Services, Parks and Forestry Operations, Parks Development, Environmental Services and Office of the City Clerk. In addition, the Financial Planning and Development Finance department has confirmed that all of the City's financial requirements associated with this subdivision have been satisfied.

Accordingly, Bathurst Contwo Investments Limited has requested the municipal services constructed in conjunction with the Yeshiva (Ner Israel) Phase 1 Subdivision Agreement be assumed by the City.

## **Relationship To Term of Council Service Excellence Strategy Map (2014-2018)**

The construction of the municipal services in the Yeshiva (Ner Israel) Phase 1 Subdivision and its assumption are consistent with the initiatives outlined in the Term of Council Service Excellence Strategy Map. The assumption of these municipal services will:

- Invest, renew and manage infrastructure and assets;
- Attract investment and create jobs;
- Continue to ensure the safety and well-being of citizens; and
- Continue to cultivate an environmentally sustainable city.

## **Regional Implications**

There are no Regional implications with respect to the assumption of the municipal works within this subdivision development.

**Conclusion**

The construction of the roads and municipal services associated with the Yeshiva (Ner Israel) Phase 1 Subdivision, Plan of Subdivision 65M-3650, has been completed in accordance with the subdivision agreement. Accordingly, it is recommended that the roads and municipal services in 65M-3650 be assumed and the Municipal Services Letter of Credit be released.

**Attachment**

1. Location Map

**Report prepared by:**

Kevin Worth, Engineering Technologist - Development, ext. 8670  
Frank Suppa, Manager of Development Inspection and Grading, ext. 8073

Respectfully submitted,

JOHN MACKENZIE,  
Deputy City Manager  
Planning and Growth Management

ANDREW PEARCE,  
Director, Development  
Engineering & Infrastructure  
Planning

# ATTACHMENT No. 1

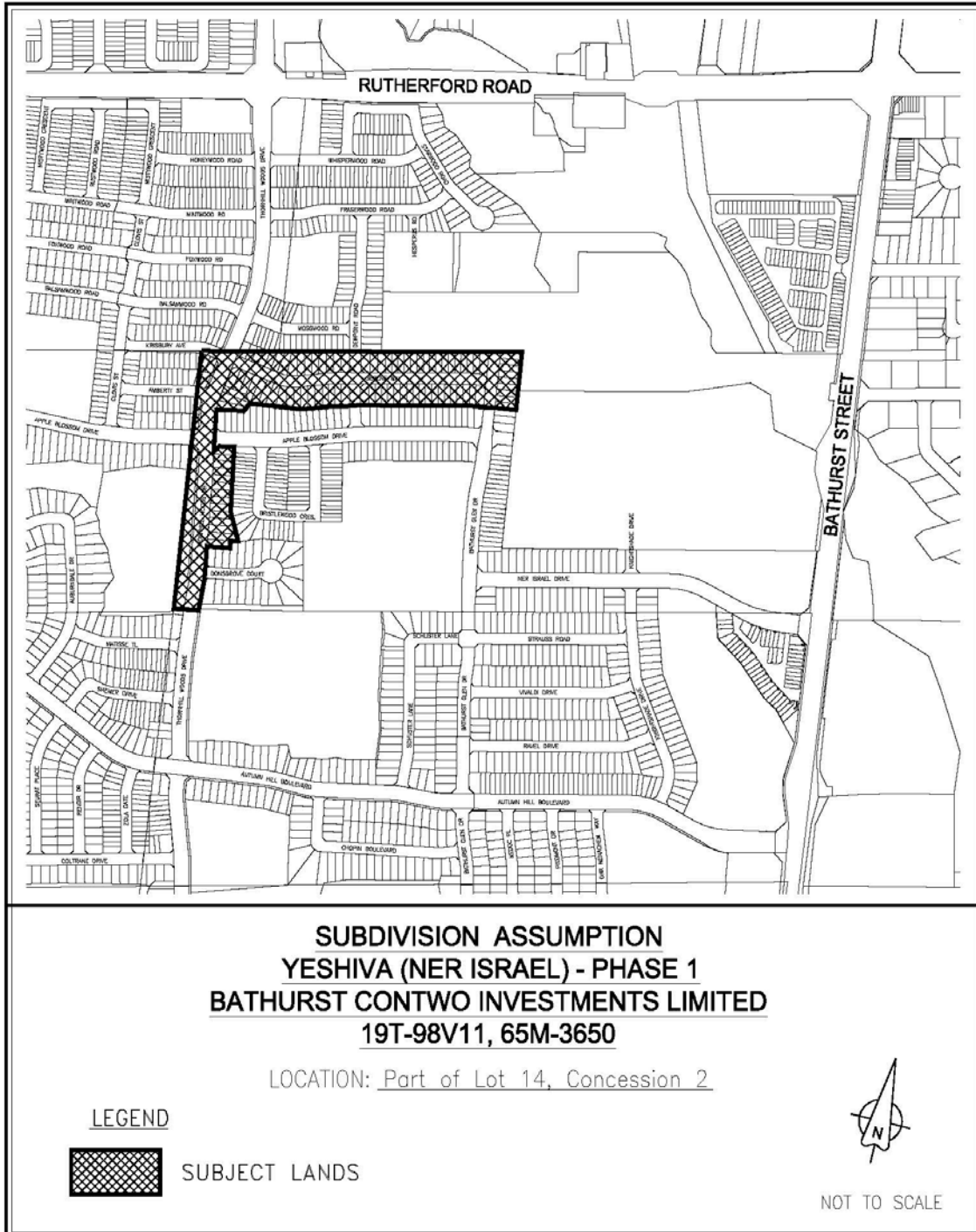

# ***THE CITY OF VAUGHAN***

# ***BY-LAW***

## **BY-LAW NUMBER 106-2017**

**A By-law to assume Municipal Services in Yeshiva (Ner Israel) Subdivision, 19T-98V11, Registered Plan 65M-3650.**

WHEREAS the Subdivision Agreement between the City of Vaughan and Bathurst Contwo Investments Limited provides for the installation of certain public services.

AND WHEREAS the Deputy City Manager Planning and Growth Management has received certification that the services in Registered Plan 65M-3650, have been constructed and installed in accordance with City specifications.

NOW THEREFORE the Council of The Corporation of the City of Vaughan ENACTS AS FOLLOWS:

1. THAT the services in Registered Plan 65M-3650, more particularly described in the Subdivision Agreement between The Corporation of the City of Vaughan and Bathurst Contwo Investments Limited dated November 15, 2002, be and they are hereby assumed as public services.

Enacted by City of Vaughan Council this 26<sup>th</sup> day of September, 2017.

---

Hon. Maurizio Bevilacqua, Mayor

---

Barbara A. McEwan, City Clerk