

# Drawing/Plan Requirements (Minor Variance)

Please provide one copy of a drawing/plan that includes the following information (incomplete drawing/plan will render a submission incomplete). Additional drawings may be submitted to support your application. All information provided in your submission will be made available to the public.

| Check Box                | Drawing / Plan Requirements (if applicable)   |
|--------------------------|---|
| <input type="checkbox"/> | The dimensions are <b>legible</b> and shown in metric (metres). Please remove grading information from plan to improve clarity, if required. For larger plans, please enhance font size for required dimensions and variances.  |
| <input type="checkbox"/> | The boundaries of the subject land are dimensioned.   |
| <input type="checkbox"/> | Highlight all requested variances (i.e. circle dimension). In instances where dimension is not available (i.e. maximum lot coverage, minimum % landscaping etc.), a site statistics chart can be included to indicate variance. An elevation drawing is required to support building height variances (circle height measurement on plan) |
| <input type="checkbox"/> | The size (length and width dimension) of all existing and proposed buildings and structures on the subject land has been provided.  |
| <input type="checkbox"/> | All existing and proposed buildings and structures on the subject land (e.g. dwelling, cabana, pool, deck, air conditioning units, wells, septic tanks, retaining walls etc.) have been labeled on the plan and confirmed as "existing" or "proposed".  |
| <input type="checkbox"/> | Existing and proposed setbacks for all buildings and structures have been indicated to the front yard lot line, rear yard lot line and side yard lot lines.   |
| <input type="checkbox"/> | The location of all features on the subject land and adjacent land (e.g. buildings, railways, roads, watercourses, drainage ditches, valley and stream corridors, wetlands, woodlands, wells and septic tanks).   |
| <input type="checkbox"/> | All private trees (over 20 cm) on the subject lands and all private or public trees within 6 metres of the subject land must be shown on the plan or have been provided separately in an Arborist Report prepared by a Certified Arborist which also identifies any of the trees that may be altered, injured or removed during work.     |
| <input type="checkbox"/> | The use of the abutting land (e.g., residential, commercial etc.) is shown on the plan.   |
| <input type="checkbox"/> | The location, width and name of any roads within or abutting the subject land, indicating whether it is an unopened road allowance, a public travelled road, a private road or right-of-way.  |
| <input type="checkbox"/> | The location and nature of any easement affecting the subject land.   |
| <input type="checkbox"/> | North Arrow   |

## Sample Drawing/Plan

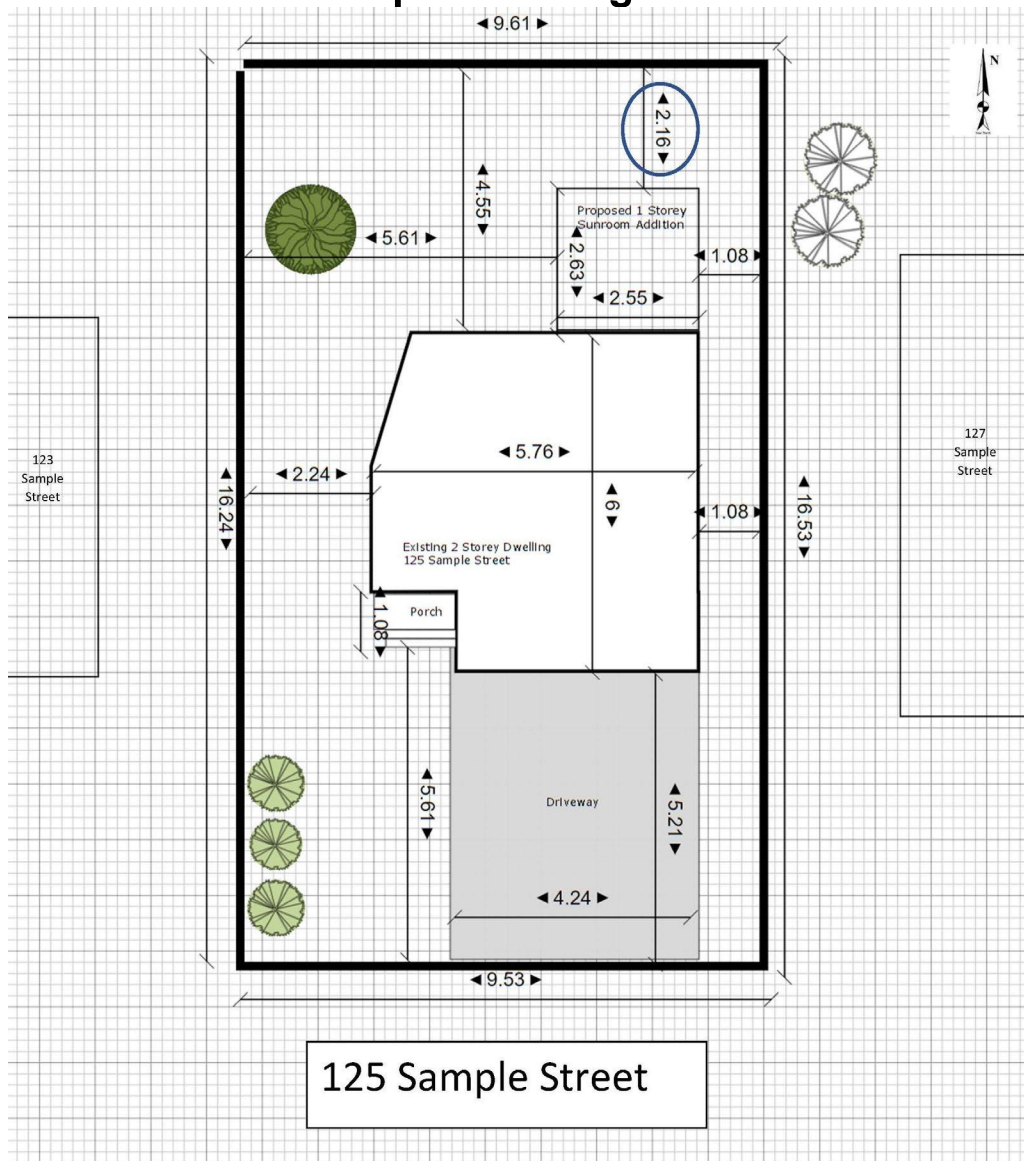

\* Sample drawing/plan provided for information purposes only, dimensions not to scale.